

Corrections with Live Move

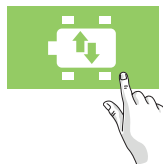

Check soft foot

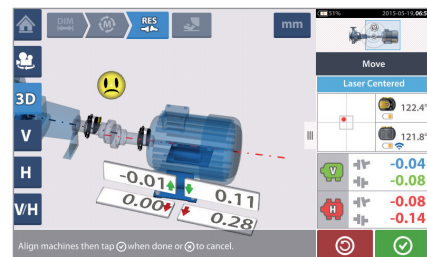
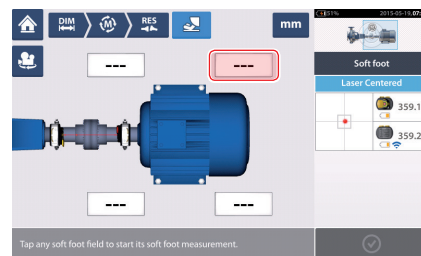

Save measurement file

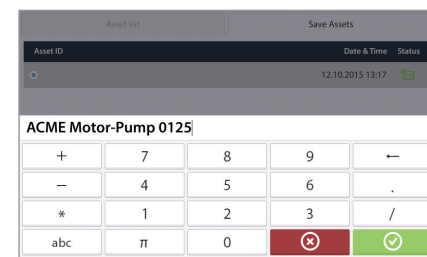
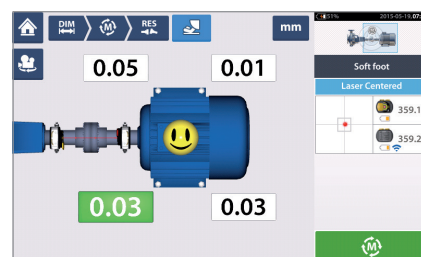
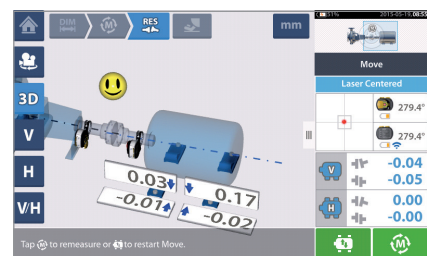
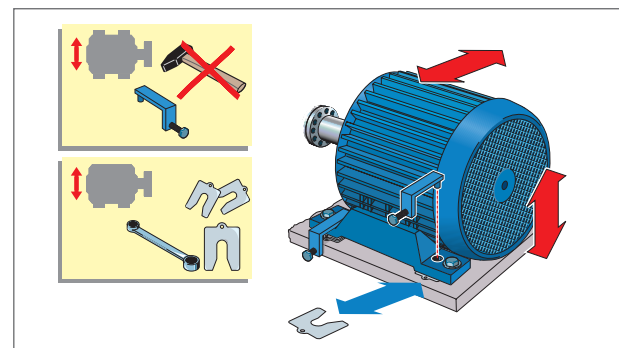
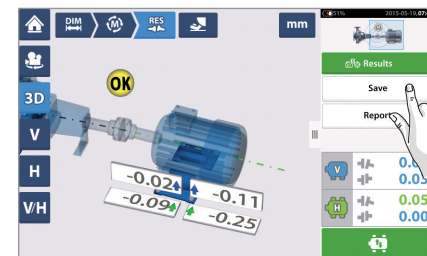

Generate measurement report

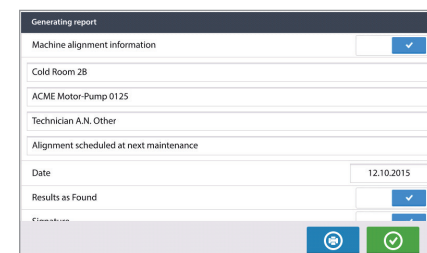
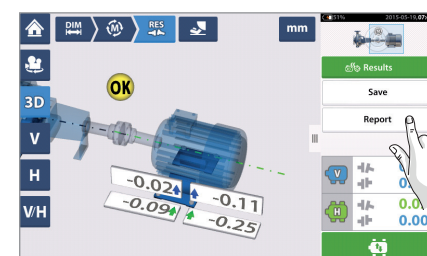

ROALIGN® touch Shaft – Pocket guide

ROALIGN® touch computer



ROALIGN® touch computer ALI 50.200

sensALIGN® sensor and laser

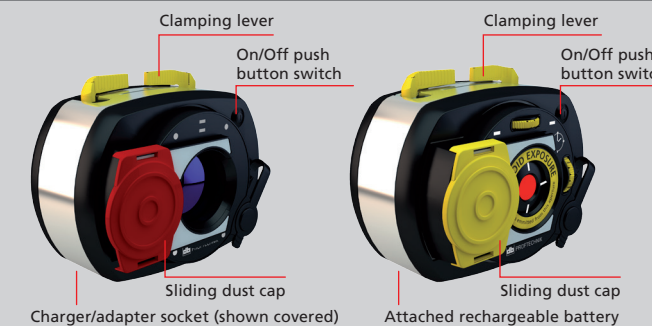

sensALIGN sensor ALI 4.900

sensALIGN laser ALI 4.910

Contact

PRÜFTECHNIK
Condition Monitoring GmbH
Oskar-Messter-Str. 19 – 21
85737 Ismaning, Germany
www.pruftechnik.com
Phone: +49 89 99616-0
Fax: +49 89 99616-300
Email: info@pruftechnik.com



1. Mount components

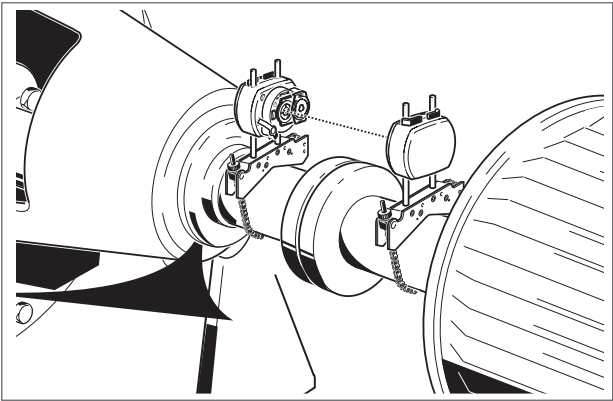
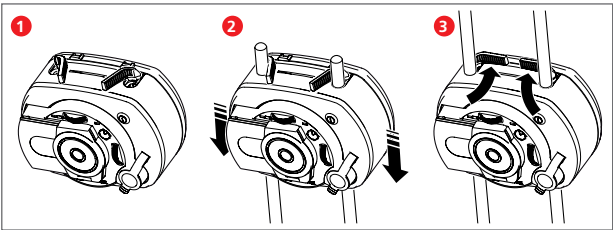
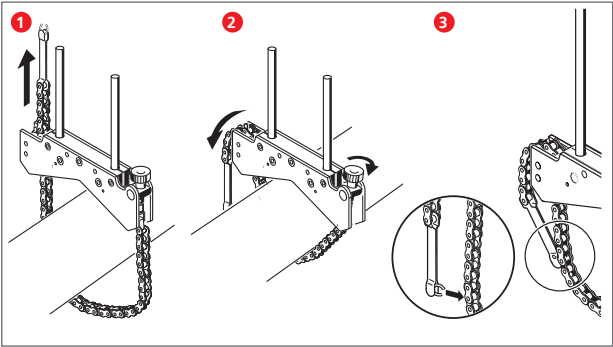

2. Switch components on

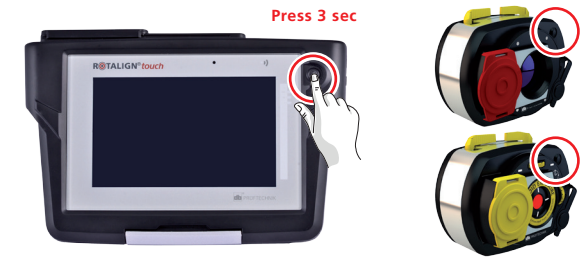

3. Start application



4. Enter dimensions

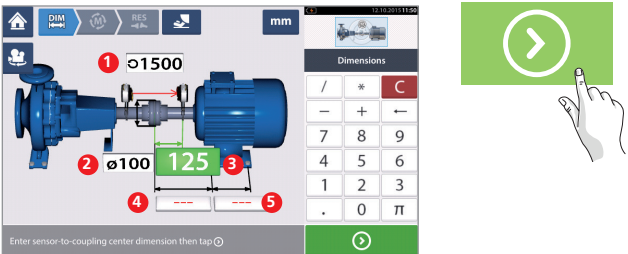
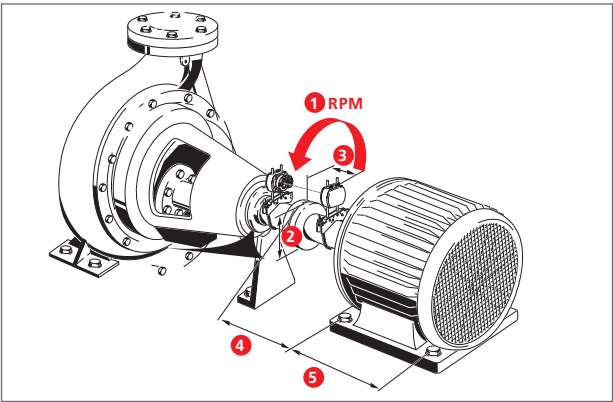

5. Adjust laser and measure

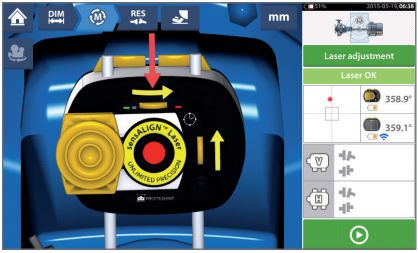

6. View results



- 1 Vertical feet position
- 2 Horizontal feet position
- 3 Vertical coupling results
- 4 Horizontal coupling results
- 5 Selected results mode
- 6 Alignment condition vector tolerance icon
- 7 Horizontal and Vertical foot results in 3D

Sign convention

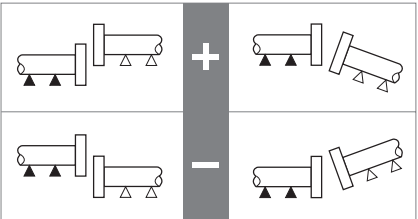

Vector tolerance

