

MDL Series Sanitary Positive Displacement Pump

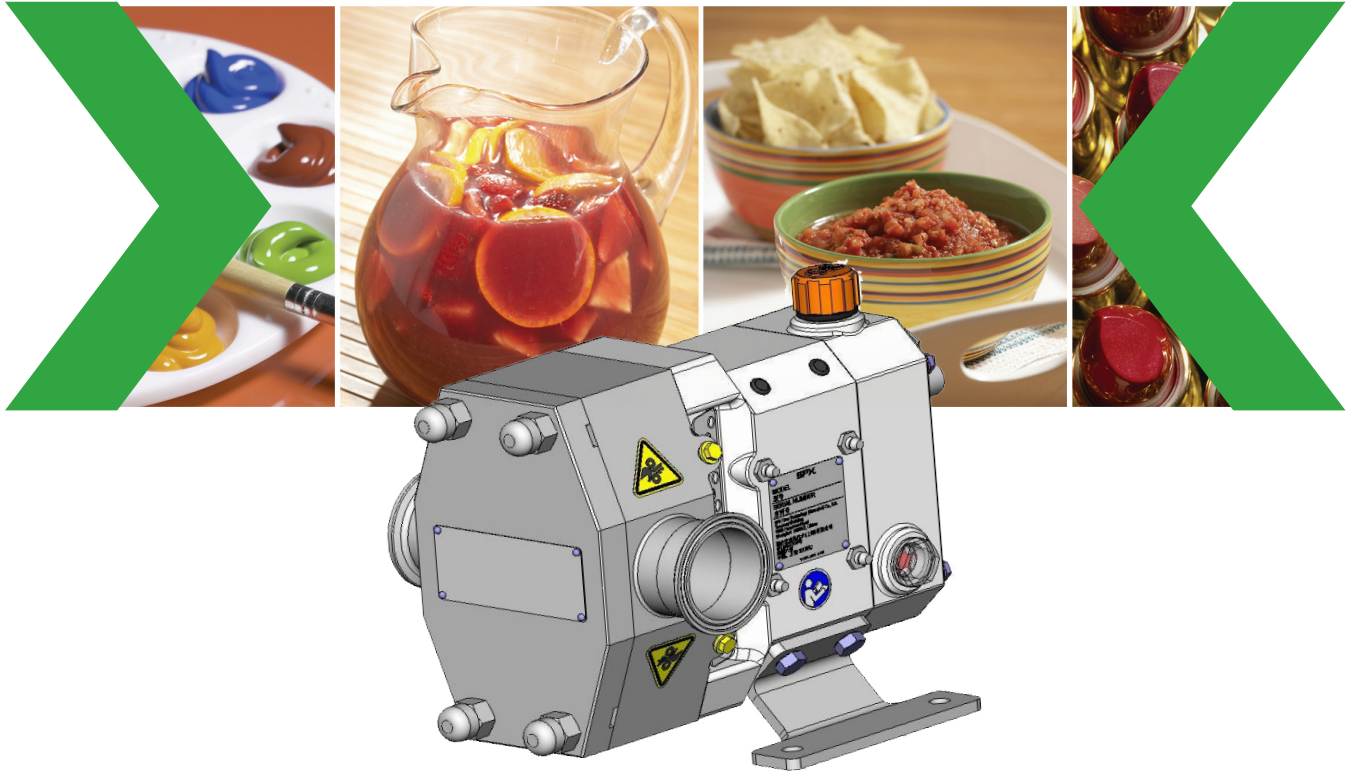

Sanitary Positive Displacement Pump with optimal efficiency

For more than half a century, Waukesha Cherry-Burrell has been a leader in the design, manufacture and application of positive displacement pumps. Waukesha Cherry-Burrell is dedicated to raising productivity, product quality and profitability for its equipment and systems customers. From this dedication has come advancements in equipment development and applications; advancements that have changed the way designers solve problems. Waukesha Cherry-Burrell PD pumps are in thousands of challenging sanitary, chemical and industrial applications around the world.

Operational Features

- Smooth flow
- Gentle product handling
- Dry running ability with double seal
- Handles low and high viscosity products
- Simple maintenance
- Hygienic design
- Low sound level
- CIP capability standard
- Free draining pump housing
- Unique rotor attachment
- Robust construction
- Process flexibility
- Single mechanical seals standard. Optional double mechanical seals also available
- Greased lubed bearings for positive lubrication over speed, temperature and pressure ranges

Installation Features

- Bi-directional flow
- Easy service and maintenance
- Horizontal or vertical mounting
- Easy to disassemble/assemble
- 316L stainless steel pump body and cover
- Versatile 4-way mounting of gear case, including vertical alignment of ports

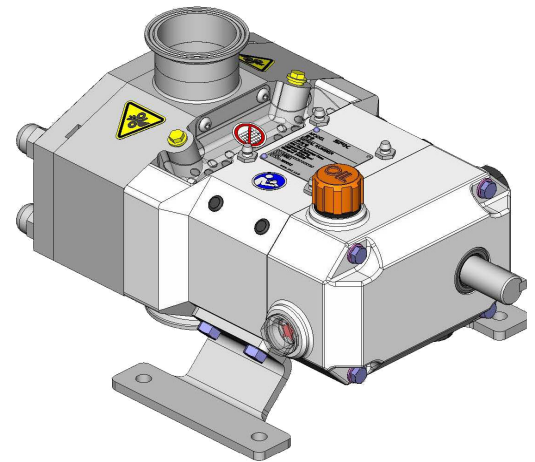

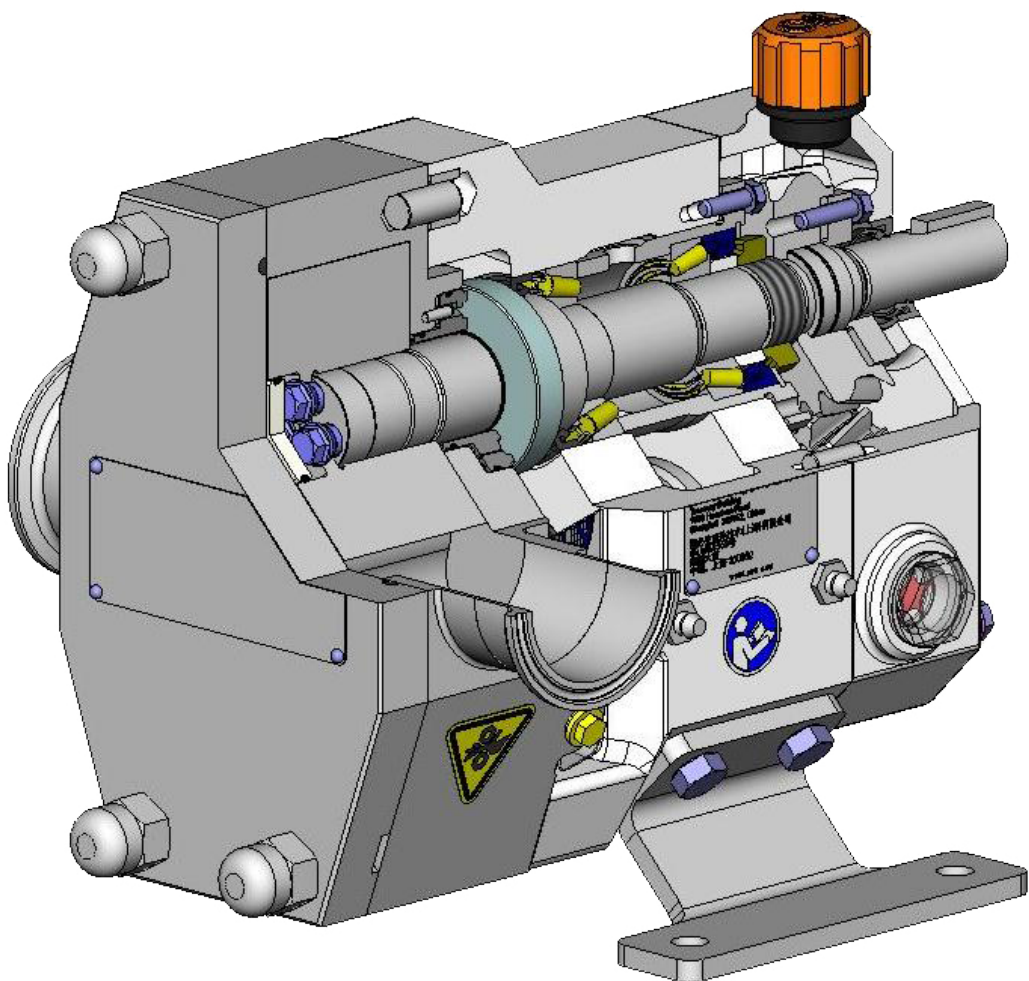

Product Benefits

- Pumps with flushed double mechanical seals can run dry indefinitely
- Very low shear, product not damaged during pumping
- No internal rotor contact
- Large fluid cavities can pump liquids with large solids
- No cross-contamination of lubricating oil into product zone due to unique gear case design
- Pumps are energy efficient and easily cleaned, maintained, and repaired

Typical Product Applications

Bakery

Batters
Flavorings
Frostings
Fruit Fillings
Fats & Oils
Sweeteners
Yeast Slurry



Beverage

Beer, Wort, Yeast
Soft Drinks
Fruit Concentrates
Fruit Drinks



Canning

Baby Foods, Soups, Stews
Tomato Paste
Fruit Puree
Vegetables, Diced, Slurries
Puddings, Jams, Jellies
Salad Dressings, Mayonnaise



Confectionery

Syrups
Cream Fillings
Chocolate

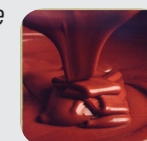

Cosmetics

Face Creams & Lotions
Hair Styling Gels & Liquids
Essential Oils
Dyes & Alcohols

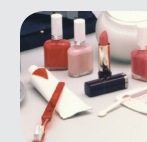

Dairy

Cream, Milk
Cheese Curd & Whey
Cottage Cheese
Yogurt

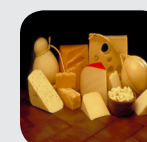

Meat Packing

Meat Emulsions
Ground Meats
Pet Foods
Ruffie & Caul Fat



Pharmaceutical

Pill Pastes
Syrups
Extracts
Emulsions
Slurries



Chemical/Industrial

Solvents
Fuels
Oils & Lubricants
Paints
Resins & Polymers
Soaps
Sludges



Performance and long life through engineering

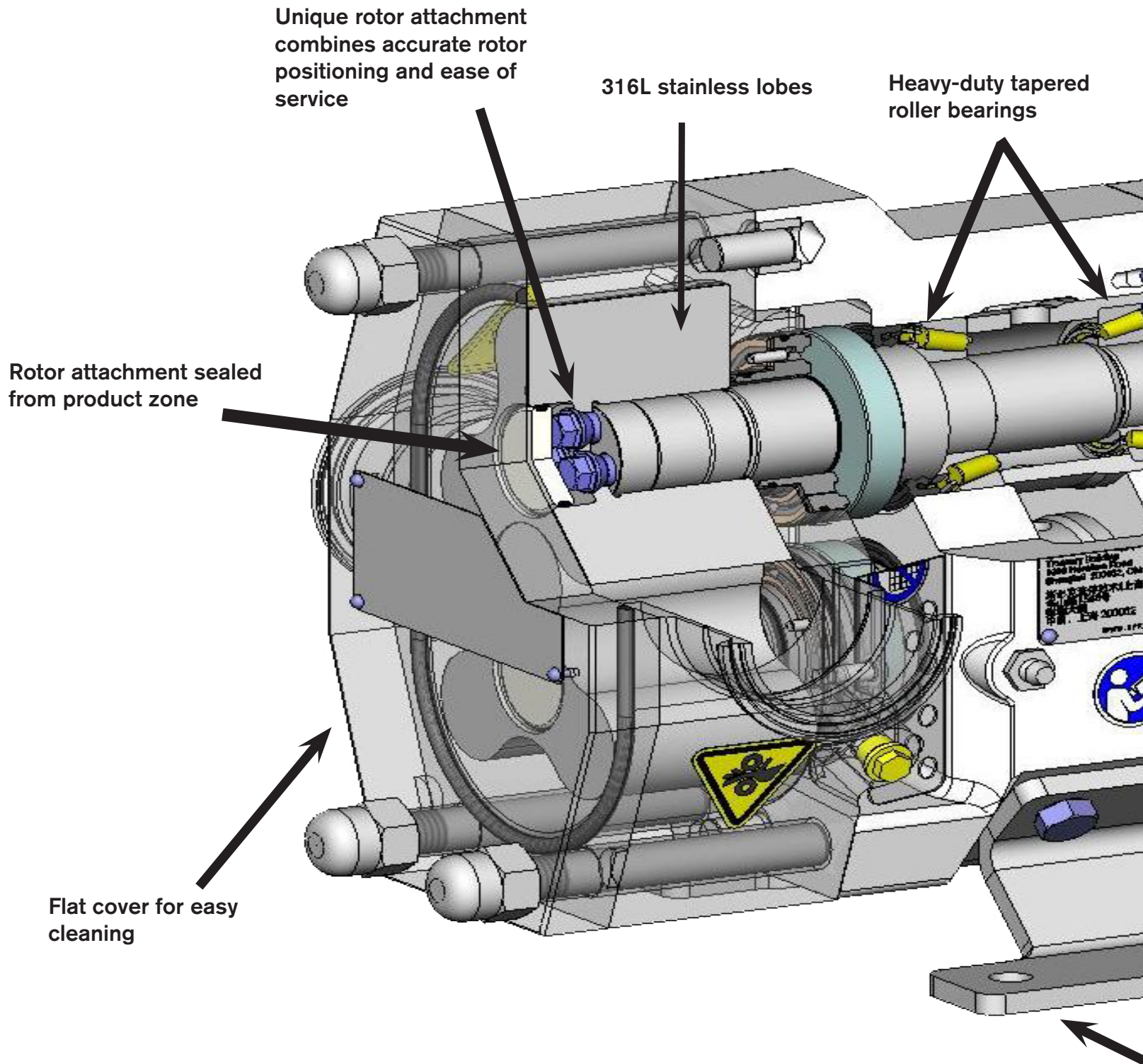

Easy access to shims for rotor clearance adjustment

Robust bearing arrangement - pre-loaded tapered roller bearings require no shimming

Easy to set and maintain rotor timing

Helical gears provide for smooth power transmission

Sight glass allows for easy indication of oil level

Versatile mounting capabilities

Seal Options

Single Mechanical Seal*

Standard carbon vs. hardened stainless steel faces provides long life in most applications.

Optional silicon carbide vs. silicon carbide adds protection against abrasive wear.

Elastomer choices for "O" rings:

- Fluoroelastomer (FKM)
- EPDM

*Mechanical seal material option:

- Carbon vs. Hardened Stainless Steel
- Silicon Carbide vs. Silicon Carbide

Double Concentric Mechanical Seal*

Used with flushing fluid to cool, lubricate, and rinse away residue. Best arrangement for severe service.

Performance overview

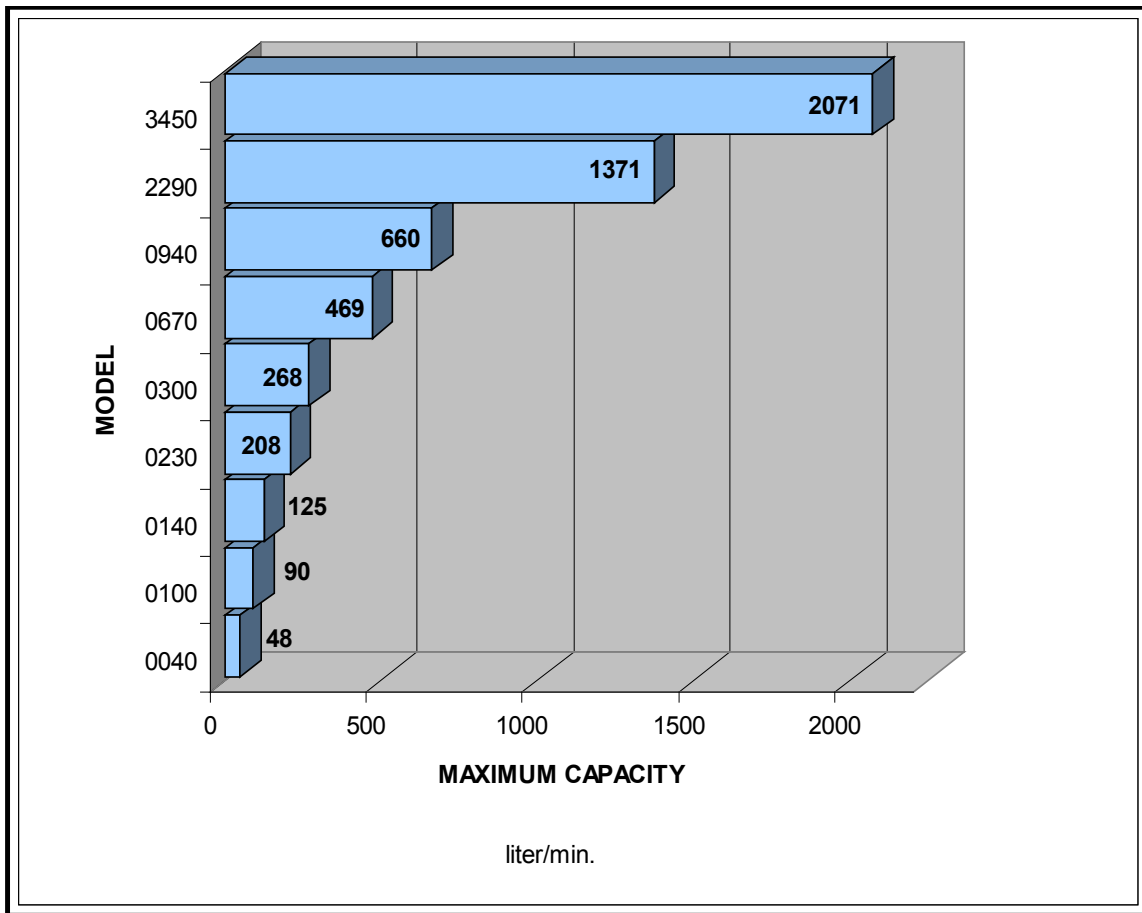

Technical data

Model	Displacement liter/rev	Nominal Connection Size	Differential Pressure Rating Bar	Maximum Pump Speed RPM	Input Shaft Diameter (mm)	Maximum torque N-m
0040	0.04	25 (1")	10	1200	19	80
0100	0.10	25 (1")	10	900	19	80
0140	0.14	38 (1.5")	10	900	19	80
0230	0.23	38 (1.5")	10	900	19	80
0300	0.30	50 (2")	10	900	19	80
0670	0.67	50 (2")	10	700	38	225
0940	0.94	75 (3")	10	700	38	225
2290	2.29	100 (4")	10	600	55	1070
3450	3.45	150 (6")	10	600	55	1070

Dimensions

**ISO 9001
CERTIFIED**

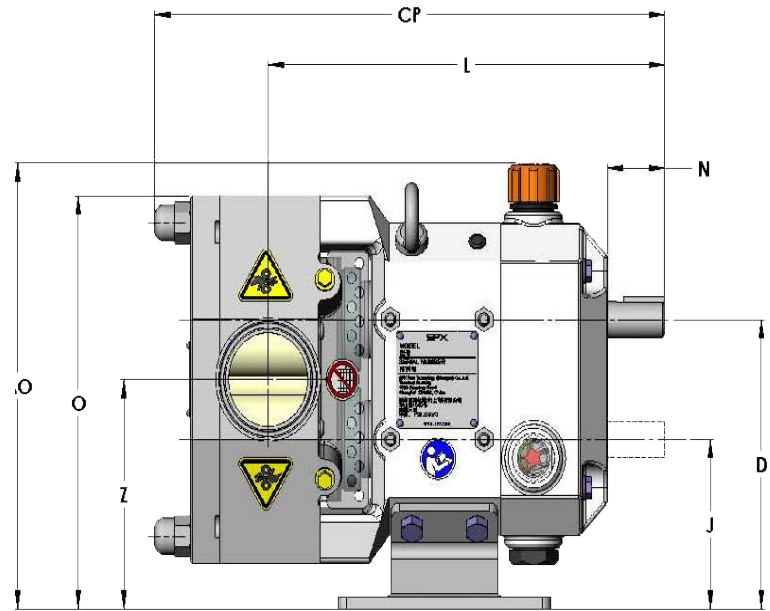
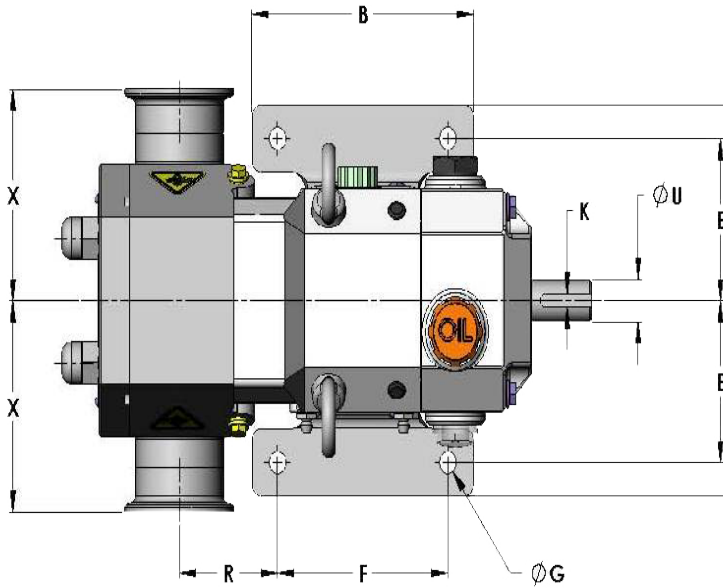

MODEL	A	AO	B	CP	D	E	F	G
0040	175.5	230.5	130.0	281.4	149.6	72.8	100.0	10
0100	175.5	230.5	130.0	286.8	149.6	72.8	100.0	10
0140	175.5	230.5	130.0	298.7	149.6	72.8	100.0	10
0230	175.5	230.5	130.0	299.1	149.6	72.8	100.0	10
0300	175.5	230.5	130.0	311.1	149.6	72.8	100.0	10
0670	239.1	310.6	160.0	396.4	205.9	99.5	120.0	13
0940	239.1	310.6	160.0	423.9	205.9	99.5	120.0	13
2290	301.1	384.6	250.0	553.6	263.7	130.5	210.0	13
3450	301.1	384.6	250.0	605.6	263.7	130.5	210.0	13

MODEL	J	K	L	N	O	R	U	X	Z
0040	87.6	6x6	227.6	34.7	231.6	43.5	19	98.0	118.6
0100	87.6	6x6	229.0	34.7	231.6	44.9	19	98.0	118.6
0140	87.6	6x6	235.8	34.7	231.6	51.7	19	98.0	118.6
0230	87.6	6x6	235.9	34.7	231.6	51.8	19	98.0	118.6
0300	87.6	6x6	241.8	34.7	231.6	57.7	19	98.0	118.6
0670	112.9	10x8	321.0	57.6	292.9	75.5	38	124.0	159.4
0940	112.9	10x8	332.6	57.6	292.9	87.1	38	134.0	159.4
2290	138.7	16x10	437.0	85.6	368.2	81.5	55	159.0	201.2
3450	138.7	16x10	463.2	85.6	368.2	107.7	55	159.0	201.2

Service Parts Kits

Service kits available for rapid replacement of routine service items:

Product Seal Kit:

(Standard and Silicon Carbide)

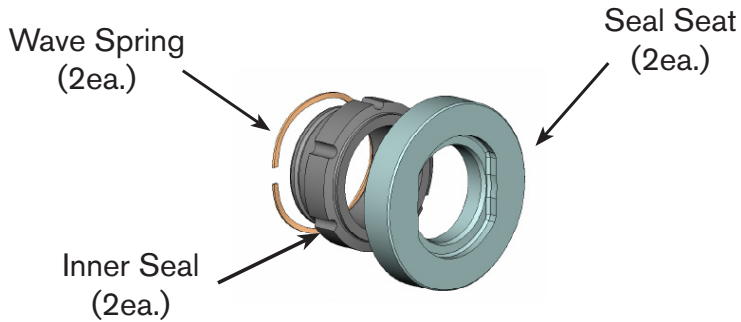

Double Seal Kit:

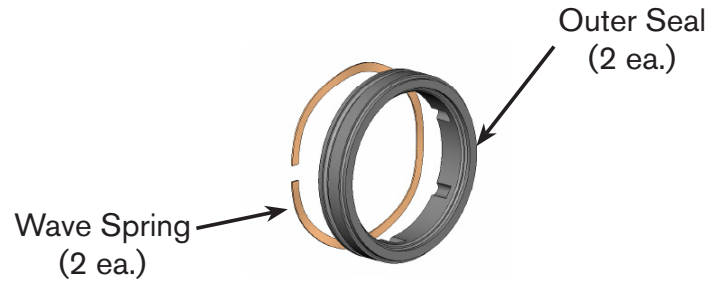

Rotor Replacement Kit:

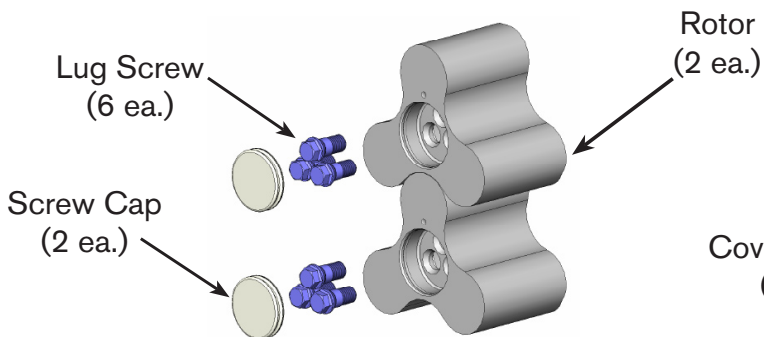

O-Ring Kits: (FKM or EPDM)

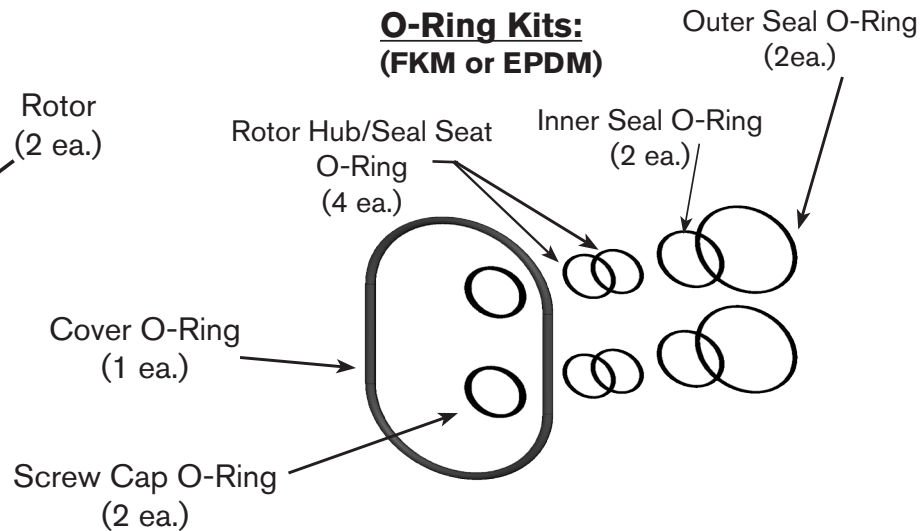

SPX®

Your local contact:

SPX Flow Technology (Shanghai) Co., Ltd
5F, Treasury Building, Hua Shan Road
Shanghai, 200052 China
Phone: +86-21-22085858 Fax: +86-21-22085866
E-mail: WCBSales-China@spx.com

For more information about our worldwide locations, approvals, certifications, and local representatives, please visit www.spx.com.

SPX Corporation reserves the right to incorporate our latest design and material changes without notice or obligation.

Design features, materials of construction and dimensional data, as described in this bulletin, are provided for your information only and should not be relied upon unless confirmed in writing.

Issued: 1/2009 FH-1751

Copyright © 2009 SPX Corporation