

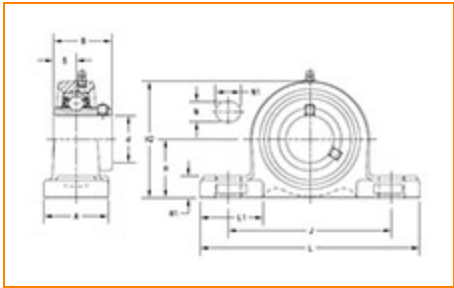

The Timken Company
4500 Mt Pleasant St. NW
N. Canton, OH 44720
Phone: (234) 262-3000
E-Mail: CustomerCAD@timken.com • **Web site:** www.timken.com

Part Number UCP311-35, UCP 300 Pillow Block Mounted Bearings - Set Screw Locking



[Specifications](#) | [Dimensions](#) | [Basic Load Ratings](#)

Specifications	
Bearing Number	UC311-35
Shaft Size d	2 3/16 in
Locking Style	Set Screw Locking
Housing Construction	Two-Bolt Pillow Block

Dimensions	
Base to Center Height H	80 mm 3.15 in
Total Length L	310 mm 12.205 in
Housing Width A	80 mm 3.150 in
Bolt Hole Spacing J	236 mm 9.291 in



Bolt Hole Size N	20 mm 0.787 in
Bolt Hole Length N1	38 mm 1.496 in
Foot Height H1	27 mm
Total Height H2	157.5 mm 6.203 in
Dimension L1	90 mm 3.543 in
Inner Ring Width B	66 mm 2.598 in
Center of Bearing from End S	25 mm 0.984 in

Basic Load Ratings

Static Load Rating	45000 N 10117 lbf
Dynamic Load Rating	71600 N 16096 lbf

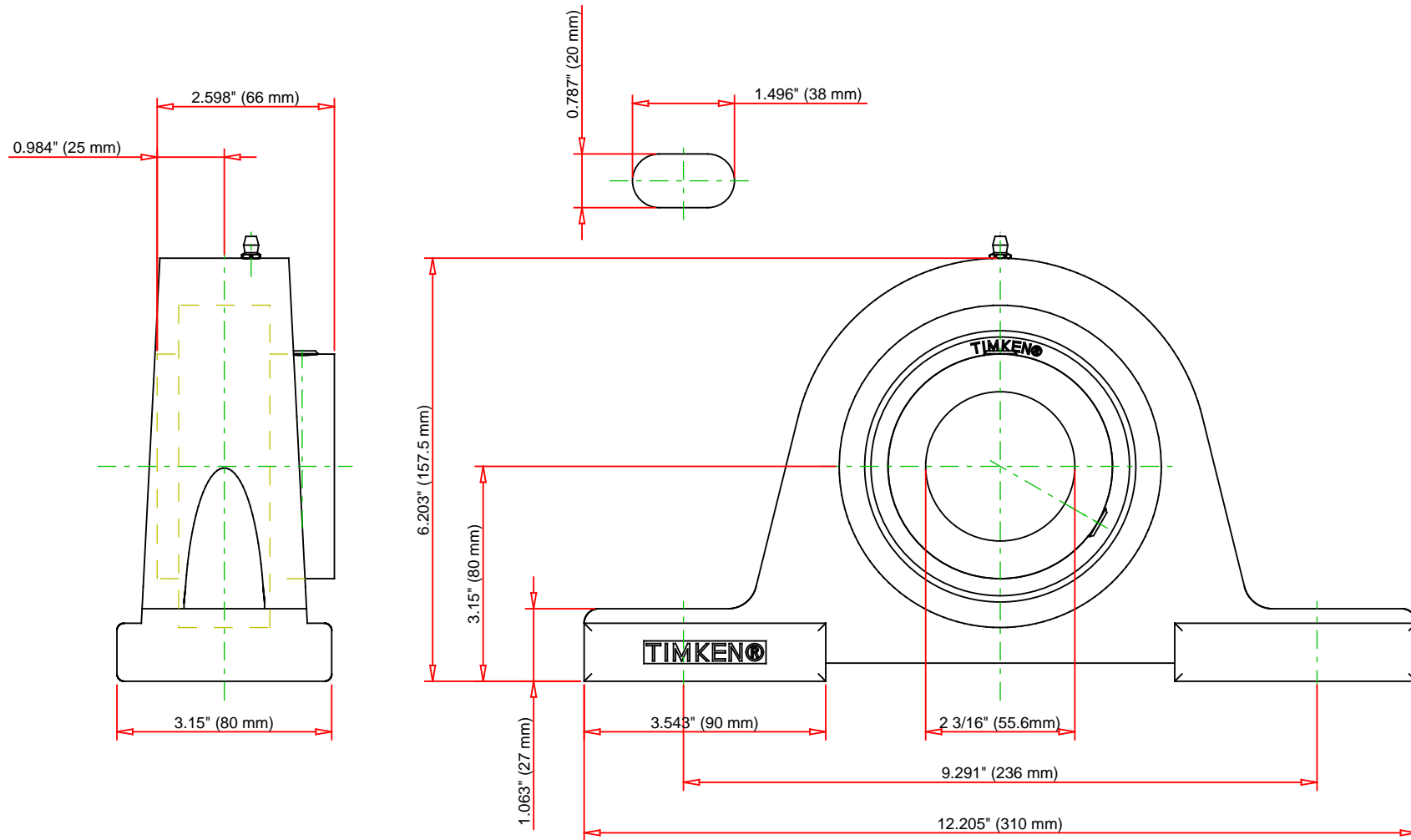

Bearing Number	UC311-35			
Load Ratings - C _r	16096	lbf	71600	N
Load Ratings - C _{0r}	10117	lbf	45000	N
Weight	17.4	lb	7.89	kg
Bolt Size	M16			

TIMKEN

THE TIMKEN COMPANY
NORTH CANTON, OHIO USA

UCP311-35

UCP 300 Pillow Block Mounted Bearings -
Set Screw Locking

Every reasonable effort has been made to ensure the accuracy of the information contained in this writing, but no liability is accepted for errors, omissions or for any other reason.

FOR DISCUSSION ONLY